

FRONT RAIL

ORDER CODES

USEABLE LENGTH	LENGTH mm	ANODISED	CONDUCTIVE ALOCHROM 1000
84HP	431,8	67123D	69349G
84HP	431,8	68951A ¹⁾	69357X ¹⁾
63HP	325,12	65336M	65337E
56HP	289,56	65338C	65339N
43HP	223,52	65340X	65341H
42HP	218,44	67702X	69388C
28HP	147,32	65342R	65343G
21HP	111,76	65344F	65345D
	1000	65346B ²⁾	
	2300	66990X ²⁾	

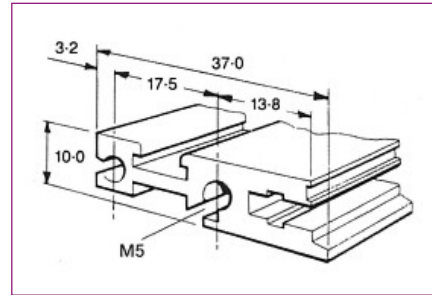

REAR RAIL TYPE 1 DIN MOUNTING

ORDER CODES

USEABLE LENGTH	LENGTH mm	ANODISED	CONDUCTIVE ALOCHROM 1000
84HP	431,8	67134R	69355C
42HP	218,44	67704F	65347M
	1000	65348E ²⁾	
	2300	66989H ²⁾	

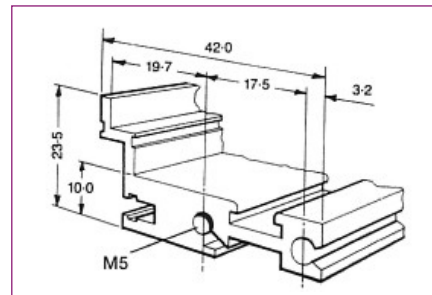

REAR RAIL TYPE 2 MOTHERBOARD MOUNTING

ORDER CODES

USEABLE LENGTH	LENGTH mm	ANODISED	CONDUCTIVE ALOCHROM 1000
84HP	431,8	68807R	69351D
42HP	218,44	69932C	69757A
	1000	65349C ²⁾	
	2300	55151E ²⁾	

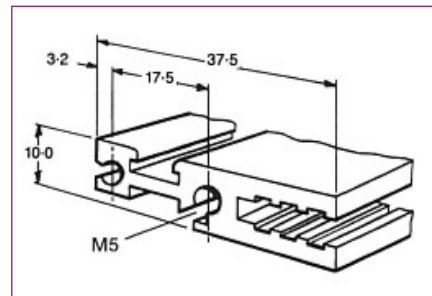

RECESS MOUNTING RAIL / DIVIDER RAIL

ORDER CODES

USEABLE LENGTH	LENGTH mm	ANODISED	CONDUCTIVE ALOCHROM 1000
84HP	431,8	68916GR	69597C
	1000	65350N ²⁾	
2300		55201A ²⁾	

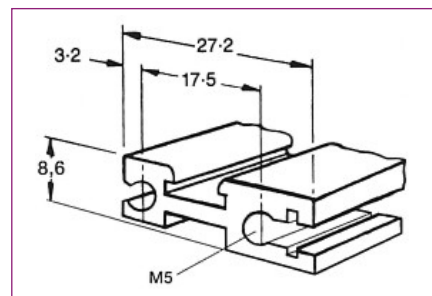

REAR RAIL SLIM TYPE 2 MOTHERBOARD

ORDER CODES

USEABLE LENGTH	LENGTH mm	ANODISED	CONDUCTIVE ALOCHROM 1000
84HP	431,8	69148D	69353M
	1000	65351X	
2300		68890G	

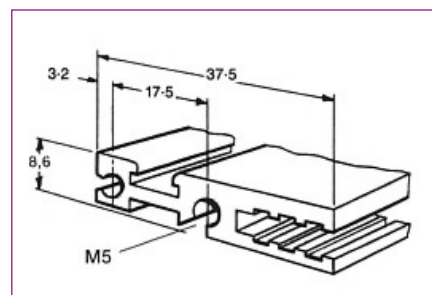

1) Lip is notched for 2 x 3U applications
2) Natural Finish